

WARNING: For correct operation & installation, it is essential to observe these instructions

SINGLE UNDERSINK WATER FILTRATION SYSTEM



CONTENTS

Single Undersink Water Filtration System 1

Installation and Operation Manual..... 3

 AquaCo Customer Service..... 3

 Operation 3

 Installation 4

 Installation requirements 4

 Typical Installation 4

 Accessories and Components List..... 4

 Installation Procedure..... 5

Cartridge Installation/Maintenance..... 6

 Faucet Installation Procedure 7

 Guide to use Push-In Tube Connectors..... 8

Use Guidelines 8

Cartridge Replacement Guide..... 9

Replacement Parts and Components..... 9

 Performance Data Sheet 10

Notes..... 12

Warranty 12

Price 14

Default 14

Severence 14

Warranty/Australia..... 15

INSTALLATION AND OPERATION MANUAL

AQUACO CUSTOMER SERVICE

Thank you for purchasing an AquaCo undersink water filter system. Your system is a proven performer manufactured from only quality materials and components and will give years of 'spring fresh' water free of impurities if maintained properly.

Caution: Do not use with water that is microbiologically unsafe or with water of unknown quality without adequate disinfection before or after the system.

The system is designed for metropolitan supply water but can be used in other situations. For other types of water supply please contact your local AquaCo stockist or call our AquaCo Customer Service Helpline.

The AquaCo filter systems cartridges need replacing regularly to maintain optimum performance. This is a simple procedure when following instructions. For cartridge replacements contact your nearest AquaCo stockist.

Customer Service Helpline 08 6156 0220 (Australia).

OPERATION

The AquaCo undersink systems are designed to run economically for many years, dependent on the initial installation and periodical maintenance.

Flush systems for 10 minutes after any period of non-use more than 2 days. For a period of non-use of 2 weeks or more, it may be necessary to replace cartridges.

This product must be installed in accordance with local plumbing regulations by a licensed plumber.

Intstallation Note: A water filter system/tap, like any product, has a limited life and may eventually fail. Also sometimes failure happens early due to unforeseen circumstances. To avoid possible property damage, this product should be regularly examined for leakage and/or deterioration and replaced when necessary. A drain pan, plumbed to an appropriate drain or outfitted with a leak detector, should be used in those applications where any leakage could cause property damage, and/or the water supply should be turned off if no one is home/present.

INSTALLATION MUST BE COMPLETED BY A LICENCED PLUMBER. FAULTY OPERATION DUE TO UNQUALIFIED PERSONS WILL RESULT IN VOIDED WARRANTY COVERAGE.

INSTALLATION

This system comes complete with an installation kit enabling it to be connected to 15mm (½") copper pipe (cold supply only - hot water should be filtered prior to heating). Included is a control valve incorporating backflow prevention, anti hammer, flow control and pressure limiting capabilities in full compliance with the relevant laws.

INSTALLATION REQUIREMENTS

1. 13 mm (½") Cold water line.
2. Min/Max pressure: 200 - 520 kPa.
3. Min/Max temperature 0° - 30°C (protect from freezing).
4. Suitable location for faucet.

Alternative fittings may be required if being connected to anything other than 15mm (½") copper pipe. No electrical or drainage requirements needed.

TYPICAL INSTALLATION

Figure 1

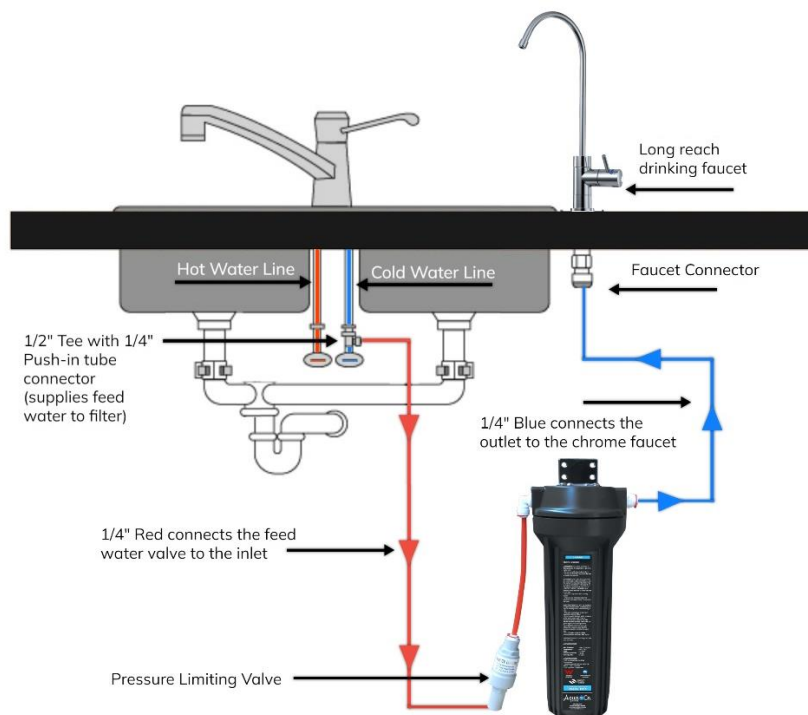

ACCESSORIES AND COMPONENTS LIST

- | | |
|--|--|
| 1. Angle stop valve (Not included) | 6. Elbow Connector 1/4" Tube to 1/4" Male |
| 2. 1/2" Tee with 1/4" Push-in Tube Connector | 7. Pre-assembled Single Undersink Water Filter |
| 3. 1/2" Braided Cold Water Hose (Not included) | 8. 1/4" Flexible Blue Tubing to Faucet |
| 4. 1/4" Flexible Red Tubing to Water Filter | 9. JG 1/4" Tube to 7/16" Female to Faucet |
| 5. Pressure Limiting Valve 350kPa | 10. High Loop Faucet with LED Indicator |

INSTALLATION PROCEDURE

1. Select suitable location that is close to the point of filtered water delivery (eg. sink). Remember to allow access room for changing filters and a suitable place where water spillage will not cause damage. Location should not be in direct sunlight.
2. Isolate water supply. Uninstall the connections on the cold water line and connect the Smart Tee™ (see Fig. 2). Reinstall the previous connection to the tee valve.
3. Connect the pressure limiting multivalve to the Smart Tee™ with a length of white tubing.
4. Choose the best position for the faucet, taking into consideration height of jugs etc. and also the drainage of any spills. Then drill a 12.5mm hole and install the faucet as in step 5.
5. To install faucet, insert the faucet into the hole in sink or bench. The faucet may be installed on any flat surface over 50mm (2") in diameter. (Remember: check the underside of the location for interference). Make a small indent using a centre punch to mark the desired drilling location. Drill a pilot hole with a metal drill. Enlarge the hole using a 1/2" metal drill bit.

Figure 2



Once the hole has been drilled install the faucet as per Figure 3. Be sure the faucet body, chrome plate, and the black rubber washer are placed above the sink. Install the black locating washer, the lock washer and nut underneath, then tighten firmly while aligning faucet in the desired direction.

6. Reset LED indicator by following instructions on page 7.
7. Install housing assembly by positioning it in the desired location, marking the position of fixing holes and fixing with mounting screws. Allow room for the connecting tubes and for removing the filter sumps (50 mm).
8. Fit tubing into connectors (for quick-connect fittings see fig 8). Allow slack in the tubing. Make sure flow is right according to inlet outlet on housing assembly. For faucet connection see figure 3.
9. Install cartridges as per cartridge installation/changeout.
10. Restore the water supply and check for leaks. The filters need to be only hand tight. If they leak then undo housing and check the O-ring is seated properly.
11. Run the system for at least 10 minutes (push the faucet lever to the upright position) to remove carbon fines. Water may appear milky, but this is normal and is only tiny air bubbles that will clear after a short period.

Figure 2

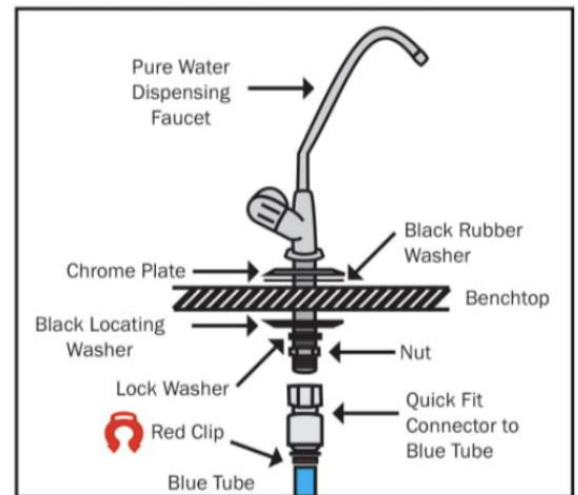

CARTRIDGE INSTALLATION/MAINTENANCE

To change the filter cartridges, adhere to the following procedure.

1. Close 1/2" Tee with 1/4" Push-In Tube Connector (Mains Connector or Shut Off Valve) to prevent water flow.
2. Relieve water pressure by operating faucet lever.
3. Unscrew filter housing sump using the spanner wrench and discard cartridges. When removing housings place a container underneath to catch any spillage. (See Fig 5)

Figure 4

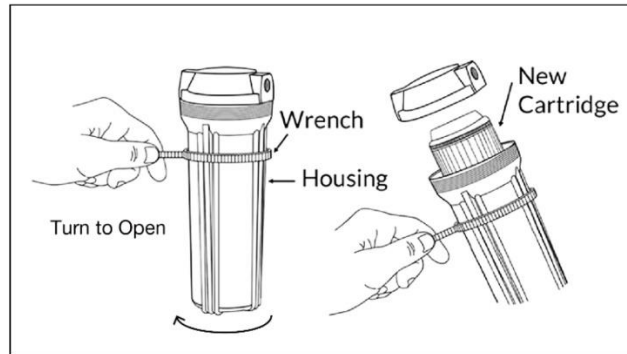

4. Cleanse the inside of the housing using warm water. Check O-ring and lubricate with food grade silicone lubricant or similar. Replace O-ring if kinked or damaged (Part No: ORG-STD). (See Fig 6)

Figure 5

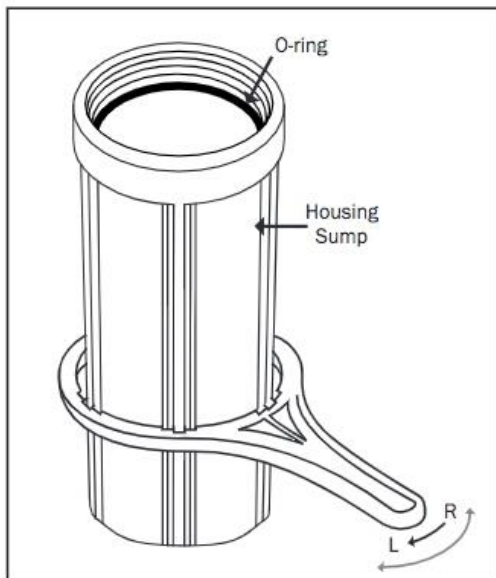
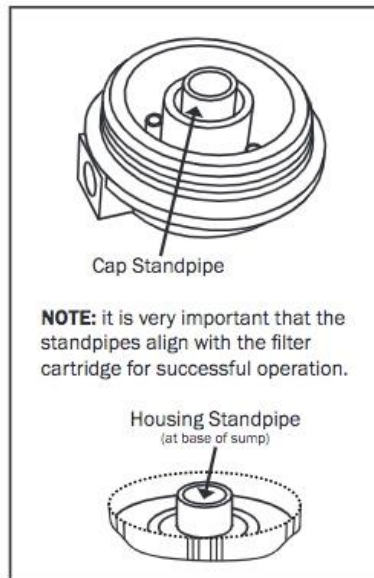
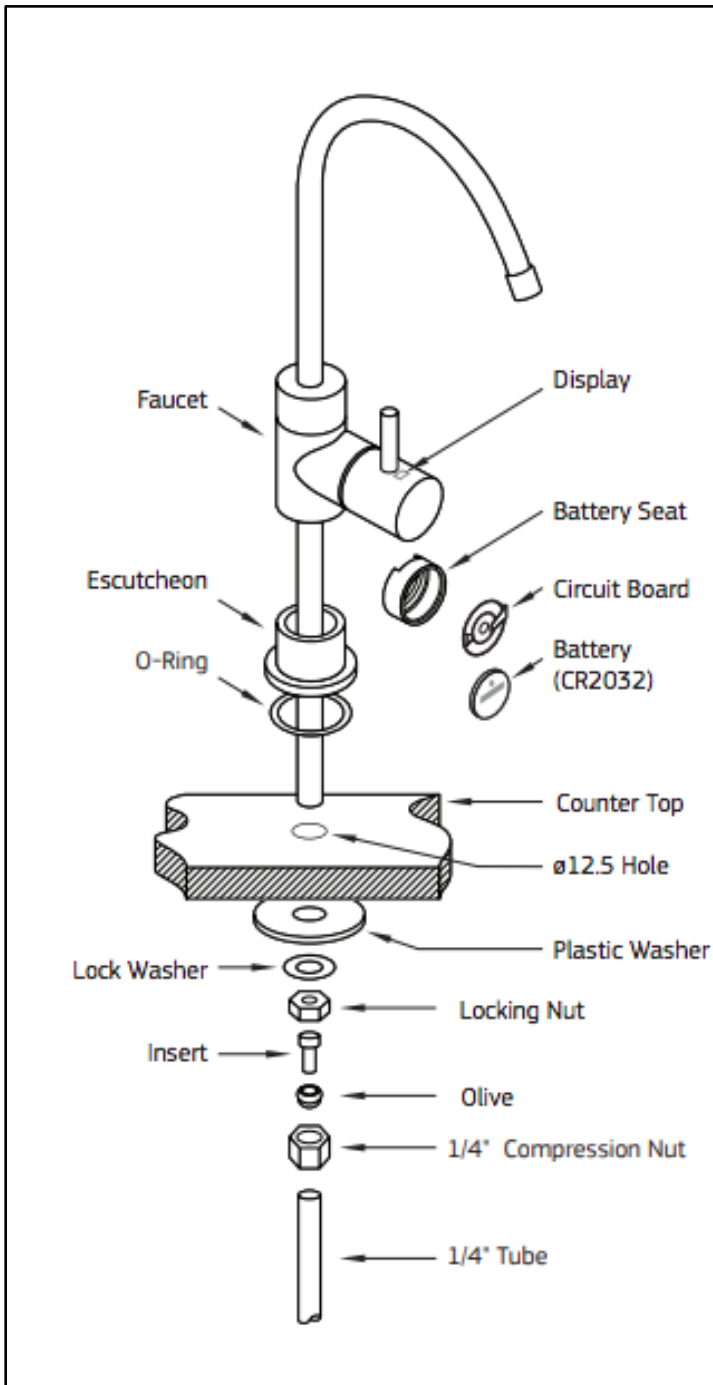

Figure 6



5. Install new cartridges and replace housing screwing them up **HAND TIGHT ONLY**. Sediment filter is on the inlet side and chemical on the outlet side.
6. Reset LED indicator by following instructions on page 7.
7. Restore water supply & check for leaks, rectifying any before leaving the unit. After installing cartridges flush unit for 5 - 10 minutes.

Figure 3 – Faucet Installation Diagram



Important note: Battery must be replaced when changing cartridges.

FAUCET INSTALLATION PROCEDURE

1. Remove the black battery seat from the faucet lever handle (see Figure 9).
2. Install battery into the battery seat, positive side up, discard plastic insert

Figure 7

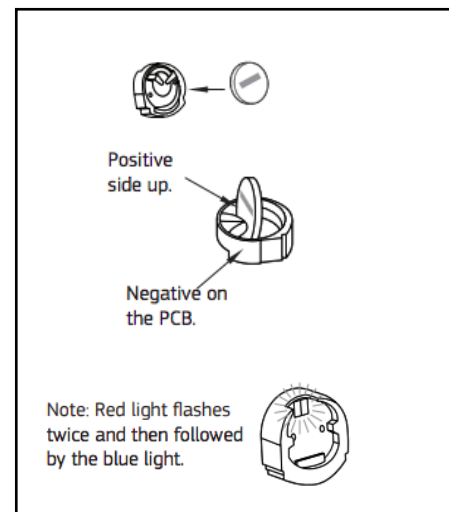

3. Reinstall battery seat assembly into the faucet lever, battery side facing outwards.

Figure 8

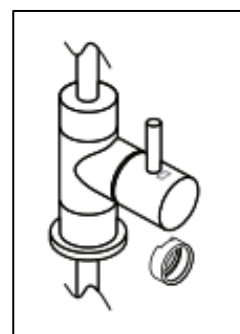
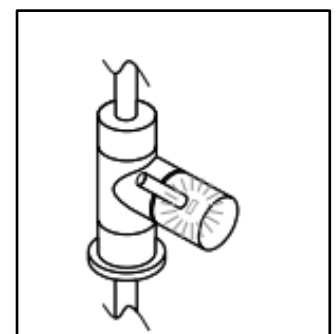

Figure 9



WARNING! THIS PRODUCT CONTAINS A BATTERY. ACCIDENTAL INGESTION MAY OCCUR AND CAN BE FATAL. PLEASE KEEP OUT OF REACH FROM INFANTS. IF YOU SUSPECT AN ACCIDENTAL INGESTION PLEASE CONTACT EMERGENCY SERVICES.

4. Blue light flashes during normal operation.
5. Red light flashes indicates your cartridges are due to be changed (usage has exceeded 12 months). Please change the battery when changing the cartridges.

GUIDE TO USE PUSH-IN TUBE CONNECTORS

Figure 10

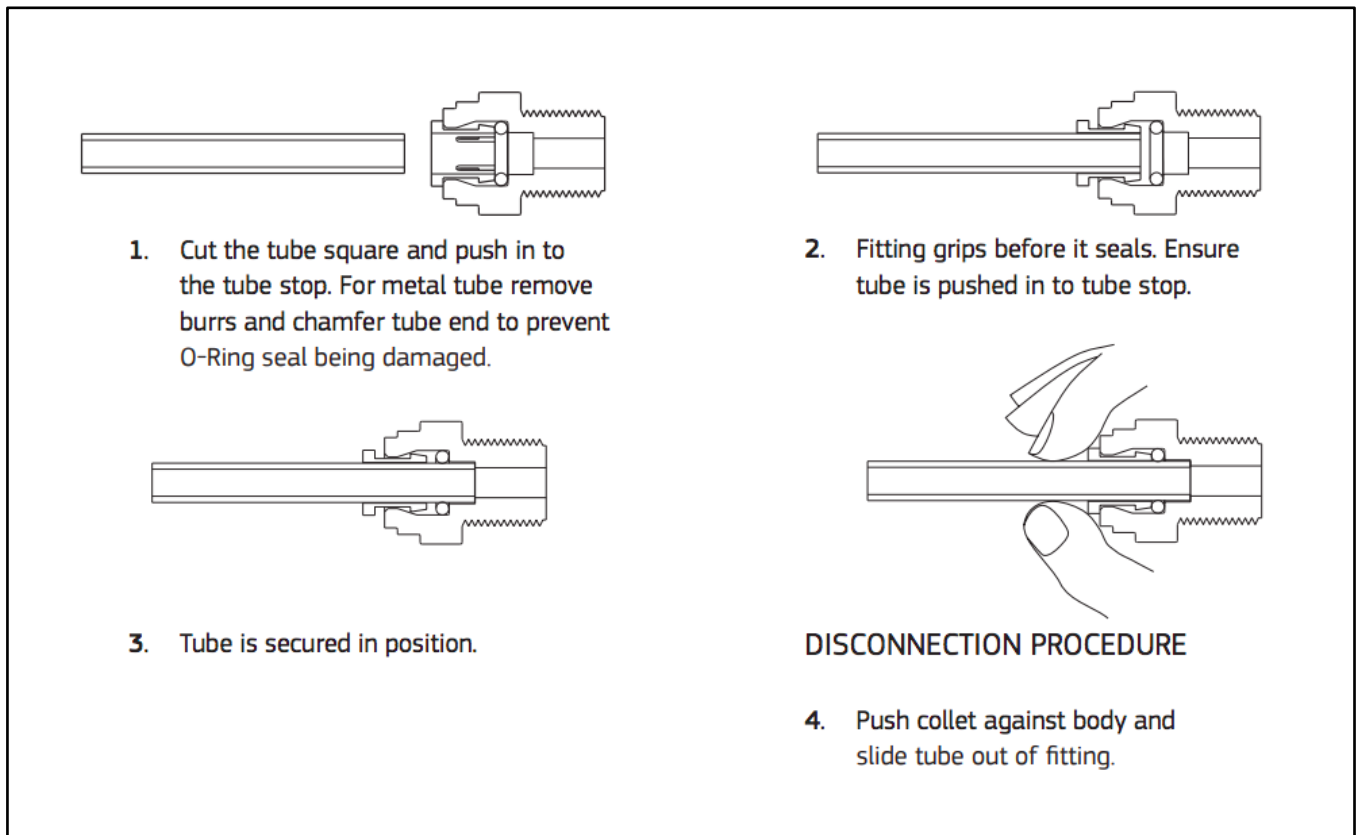

USE GUIDELINES

- Minimum operating pressure 200 kPa.
- Maximum operating pressure 520 kPa.
- Do not allow exposure to temperatures below 0°C.
- Maximum operating temperature 38°C.
- Nominal flow rate 4 Lpm.
- This system must be installed according to local plumbing codes on the cold water line.
- Replacement Cartridges: See Cartridge replacement section
- This system requires regular replacement of the filter cartridge to maintain proper operation. Varying chlorine, sediment, or organic substance levels may affect replacement frequency.
- Be sure to change the filter cartridge at least every 12 months; or whenever you detect a change in taste, odour, or decrease in flow.
- When replacing cartridge, ensure you reset the LED reminder light by removing/replacing the battery from the rubber seat. Please refer to page 8 for a detailed diagram.

Caution: Do not use with water that is microbiologically unsafe or of unknown quality without adequate disinfection before or after the system.

CARTRIDGE REPLACEMENT GUIDE

You can obtain replacements from your local AquaCo dealer. To maintain performance, reduction rates, warranty and standards use genuine AquaCo replacements.

REPLACEMENT PARTS AND COMPONENTS



Omnipure Carbon Block Replacement Filter Cartridge

- ✓ Chlorine
- ✓ Pesticides & Herbicides
- ✓ Flammable Liquids (VOCs)
- ✓ Taste, Odours & Colour
- ✓ Heavy Metals (Copper, Arsenic, Mercury, Lead)
- ✓ Parasites
- ✗ Fluoride
- ✗ Bacteria & Viruses
- ✗ Chloramines
- ✗ Scale build up reduction

NOTES: CHLORINE AND LEAD REDUCTION CAPACITIES ARE BASED ON LABORATORY TESTING CONDUCTED USING TEST PROTOCOL CONTAINED IN NSF STANDARDS 42 AND 53 RESPECTIVELY.

Version	Link
Omnipure Carbon Block Filter	Buy



Aragon Replacement Filter Cartridge

- ✓ Chlorine
- ✓ Pesticides & Herbicides
- ✓ Flammable Liquids (VOCs)
- ✓ Taste, Odours & Colour
- ✓ Heavy Metals (Copper, Arsenic, Mercury, Lead)
- ✓ Parasites
- ✗ Fluoride
- ✓ Bacteria & Viruses
- ✓ Chloramines
- ✓ Scale build up reduction

Version	Link
Aragon Filter	Buy

TO MAINTAIN THE HIGH QUALITY OF THE PURIFIED WATER THE CARTRIDGE(S) NEED CHANGING EVERY 6-18 MONTHS (THIS IS DEPENDENT ON WATER QUALITY AND USAGE). YOU CAN OBTAIN REPLACEMENT CARTRIDGES FROM YOUR LOCAL AQUACO STOCKIST. TO MAINTAIN PERFORMANCE AND WARRANTY USE GENUINE AQUACO REPLACEMENTS.

PERFORMANCE DATA SHEET

PRODUCT CODE: CB-925-1POP

CARBON FILTER

Micron Rating	>99% @ 1 µm
Filter Dimensions	9" x 2.5"
Chlorine Reduction >95%	30,000 L @ 0.75 gpm
Lead Reduction >90%	11,300 L @ 0.75 gpm
Cyst, Cryptosporidium, Giardia Reduction >99.95%	>99.99%
Initial _P	>5.0 psid @0.75 gpm
Carbon Weight	0.80 lbs.
Carbon Type	Activated Coconut Shell Carbon

NOTES: CHLORINE AND LEAD REDUCTION CAPACITIES ARE BASED ON LABORATORY TESTING CONDUCTED USING TEST PROTOCOL CONTAINED IN NSF STANDARDS 42 AND 53 RESPECTIVELY.

PRODUCT CODE: ARA-925

ARAGON FILTER

Micron Rating	>100% @0.5 µm
Filter Dimensions	9" x 2.5"
Suspended impurities (rust, sand, algae, other particles) over 0.5 µm	100%
Heavy and radioactive metals (lead, cadmium, copper, strontium-90, caesium)	>99%
Active chlorine	>100%
Organic compounds	>92%
Hardness salts	>85%
Microorganism and coliform bacillus	>99%
Hepatitis A virus, rotaviruses and Noroviruses	>99%
Capacity	7,000 L @0.3 mg/l of iron 35,000 L @0.06 mg/l of iron

* DEPENDS ON CONTAMINATION DEGREE OF INITIAL WATER

** GIVEN THE IRON CONTENT OF WATER UP TO 1 MG/L WITH CONSIDERATION FOR REGENERATION

*** AT HARDNESS UP TO 3 MG-EQ/L WITH CONSIDERATION FOR REGENERATION

Aragon Filter Certifications:

- Certified by Institut Pasteur de Lille (France)
- Certified by S.M Kirov Military Medical Academy (Russia)
- Certified by The Research Institute of Influenza (Russia)
- Certified by V.G Khlopin Radium Institute (Russia)
- Certified by The Research Institute of Epidemiology and Microbiology (Russia)
- Certified by IFTS (France)
- Certified by IAPMO (United States)
- Certified by University of Ferrara (Italy)

In accordance with the test report based on the filtration of the artificially contaminated ultra-clean water, the GEYSER ARAGON BIO filters are capable to remove the bacterial and viral contamination with the following parameters:

- Legionella pneumobilia, Serogroup 1 (CIP 103854): mean removal efficiency 99.99987 % (5.9 log)
- Salmonella Typhimurium (ATCC 14028): mean removal efficiency 99.998 % (4.8 log)
- Poliovirus, Sabin Strain of Type 1: mean removal efficiency 99.84 % (2.8 log)
- Rotavirus, Simiens Strain SA114F1: mean removal efficiency 99.99 % (4.0 log)
- Hepatitis A virus, Strain HM175/18f (ATCC VR-1402): mean removal efficiency 96 % (1.4 log)

NOTES

AquaCo water care products are designed, manufactured and supported by Water Filters Pty Ltd the name you can trust for viable and proven water solutions. The complete range of AquaCo products are developed, refined, made to meet and exceed stringent specifications for the worldwide market.

Important: Sales of products are subject to our Terms and Conditions which are available upon request. All specifications, information and photos are a guide only and are subject to change without notice. Please ring to confirm details. Warning: For correct operation of this appliance it is essential to observe manufacturer's instructions.

WARRANTY

Any contract of sale, order, or quotation made or accepted by or on behalf of Water Filters Pty Ltd (trading as AquaCo Filters) is subject to these terms and conditions of sale.

- AquaCo Filters warrants AquaCo Filtration Systems to the original purchaser for a period of 5 years for Retail customers, and 2 years for Wholesale and Trade customers from the date of sale established by the date of the original invoice issued by an authorized distributor.
- AquaCo Filters warrants each new Product to be free from defects in the product for a period of 2 year from the date of retail sale established by the date of the original invoice issued by AquaCo Filters.
- AquaCo Filters reserves the right in instalment sales to grant credit for the value of any Product found to be defective under this Warranty.
- AquaCo Filters will not cover any labour charge incurred by the Buyer for the replacement or repair of any Product.
- The Buyer is responsible for freight and local labour charges for Products the subject of this Warranty.
- This Warranty applies only to the original purchaser of the Product.
- AquaCo Filters' obligation under this Warranty is limited to AquaCo Filters' own option, to either repair or replace the Product, once AquaCo Filters has deemed that the Product is defective or AquaCo Filters may, at its own discretion, refund to the Buyer the purchase price paid for the defective goods.
- This Warranty does not cover any Product that is relocated from the site of its original installation.
- All replaced or exchanged parts taken out under this warranty become the property of AquaCo Filters.
- This Warranty is subject to the Product being properly installed, maintained, being used for its intended purpose and operated strictly in accordance with AquaCo Filters' recommendations and installation guide.
- This Warranty does not extend to a Product that has been modified in any way unless with AquaCo Filters' express consent.
- This Warranty does not cover the normal wear and tear of the Product, or damage caused by misuse, abuse or vandalism. The Warranty does not cover any malfunction or failure resulting from neglect, use of unauthorised parts and accessories or use with higher water pressure than indicated on the Product.
- The Warranty does not extend to damage caused by rain, fire, earthquake or other natural causes or acts of nature.
- It is expressly agreed that this shall be the sole and exclusive remedy of the Buyer stated herein, and under no circumstances shall AquaCo Filters be liable for any costs, loss, expense, damages, special damages, incidental damages or consequential damages arising directly or indirectly from the design, manufacture, sale, use or repair of the Product whether based upon warranty, contract, tort or strict liability.
- All Conditions and Warranties implied by law or statute are hereby expressly negated so far as they lawfully can be.

ACCEPTANCE AND CLAIMS

- Acceptance of the Products shall be deemed for all purposes to have taken place at the expiration from the date of each delivery.
- Any damage caused during or as a result of transit will not be the responsibility of AquaCo Filters.
- Any faulty systems must be returned with the Pressure Limiting Valve.
- In the event of a Warranty Claim, the Product must be forwarded at the Buyer's own risk and expense to AquaCo Filters, together with proof of purchase.
- This limited Warranty is void if the Product under Warranty is presented without the said original invoice.
- AquaCo Filters may request that a Statement accompany the Original Invoice, signed by the Buyer, setting out the following terms:
 - The name and address of the Buyer.
 - The date and by whom the Product was purchased.
 - The date and by whom the Product was installed.
 - The location where the Product was installed.
 - The date and time the Product first appeared to malfunction.
 - The nature of the problem with the Product.
 - The date and time of any and all loss event/s.
 - The date and time AquaCo Filters was first notified of the Product malfunction.
- A failure by the Buyer to submit the said Statement within 28 days, after such request is made by AquaCo Filters, will automatically void the Warranty.
- A failure to answer truthfully or to answer in a way that is misleading, entitles AquaCo Filters to void the Warranty and to notify the police in the event of suspected fraudulent conduct.

RISK

- The risk in the Product will pass to the Buyer immediately upon the Product leaving AquaCo Filters' premises for delivery to the place designated by the Buyer.

RETENTION OF TITLE

- AquaCo Filters will retain title to (but not risk in) a Product delivered to the Buyer until AquaCo Filters has received payment in full for such Product from the Buyer.
- The Buyer will store the goods in such a way as to enable them to be separately identified and will keep them insured at its own expense with AquaCo Filters' interest noted on any such insurance cover.
- If the Buyer fails to make any payment when due or becomes bankrupt or becomes insolvent, or has a judgement entered against it in any Court or enters into any scheme of arrangement, composition, or assignment or is in receivership or voluntary administration or liquidation, the Buyer grants AquaCo Filters the license to enter any of the Buyer's premises where the Product is stored, and without notice, to re -take possession of and remove, at the Buyer's cost and expense, the Product in respect of which title has not passed to the Buyer.

RIGHTS FORFEITED

The Buyer forfeits any right or claim against AquaCo Filters warrantee if:

1. The System is operated with a water temperature higher than 38° Celsius.
2. The System is not serviced every 12 months. i.e. replacement of filters, PLV check and assessment of general condition of the system. If the drinking water quality is poor, the System should be serviced before 12 months.
3. The System damage results from water hammer, freezing, neglect or is not installed by a licensed plumber in accordance with the AS3500 plumbing code and installation plan.
4. The System is subject to water pressure that exceeds the maximum recommended pressure.
5. The System is not installed with an Australian Standards approved Pressure Limiting and Dual Check Valve.
6. The System has been found to be tampered with or if the goods have not been operated or maintained strictly in accordance with AquaCo Filters' recommendations.
7. The System is not turned off when the residents are away for over 24 hours.

PRICE

- The price charged shall be AquaCo Filters' price ruling at the date of delivery unless otherwise agree in writing. Any price indications or price lists are subject to alterations to AquaCo Filters' price ruling at the date service or goods are supplied.
- Prices are as per AquaCo Filters' wholesale unless otherwise agreed in writing.
- The Buyer is responsible to effect and meet the costs of any insurance cover that is deemed necessary.
- Clerical errors in computations, typing or otherwise of "catalogue, quotation, acceptance, invoice, delivery docket or other document" shall be subject to correction.
- Any goods returned through no fault of AquaCo Filters will be subject to a 15% restocking fee.

DEFAULT

On the happening of any one or more of the following events, namely:

- The Buyer fails to make payment to AquaCo Filters on the due date;
- An administrator or liquidator is appointed over any or all of the assets of the Buyer or a scheme of arrangements is proposed to approve with respect to the Buyer;
- In the case of the Buyer being a natural person, the Buyer commits an act of bankruptcy; then AquaCo Filters may at its option exercise all or any of the following rights (notwithstanding any prior failure to exercise such rights):
 - a. demand payment of the whole of the monies owing from the Buyer to AquaCo Filters and the Buyer agrees to pay the same immediately.
 - B. the Buyer shall pay to AquaCo Filters interest on such amount outstanding at the rate of 2% per month and any costs with respect to solicitors, legal advisors, mercantile agents and other agents acting on behalf of AquaCo Filters in respect of any enforcement hereof or recovery or attempted recovery of monies owing by the Buyer to AquaCo Filters.

SEVERENCE

If any of these terms or conditions become for any reason wholly or partly invalid, that term or condition shall to the extent of the invalidity be severed without prejudice to the to the continuing force and validity of the remaining terms and conditions.

JURISDICTION

AquaCo Filters and the buyer agree that this agreement and its provisions shall be construed in accordance with the laws of the State of Western Australia and be resolved by a Western Australian Court.

WARRANTY/AUSTRALIA

This warranty is given by Water Filters Pty Ltd, ABN 68618671677, telephone no. 08 6156 0220 and email at sales@waterfilter.com.au.

This warranty is provided in addition to other rights and remedies you have under law: Our goods come with guarantees which cannot be excluded under the Australian Consumer Law. You are entitled to replacement or refund for a major failure and to compensation for other reasonably foreseeable loss or damage. You are also entitled to have the goods repaired or replaced if the goods fail to be of acceptable quality and the failure does not amount to a major failure.